

NOT AS BUILT

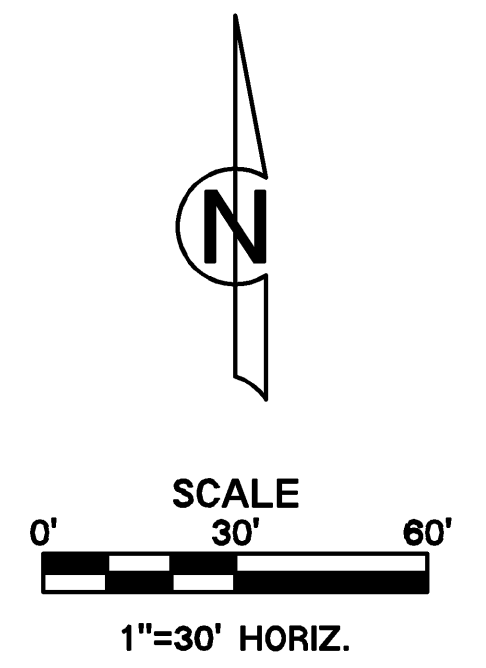
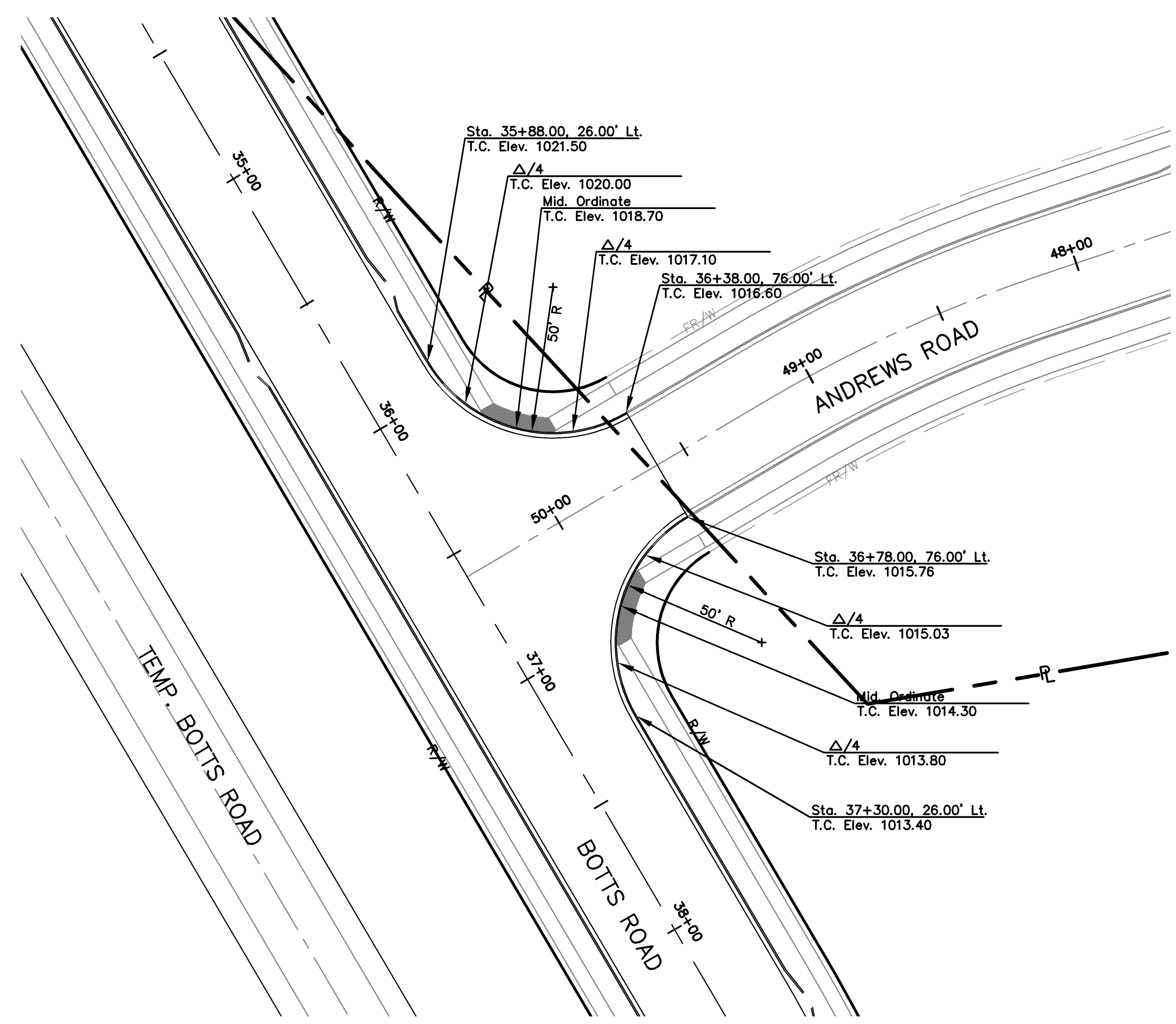

BOTTS ROAD & ANDREWS ROAD

Location: N:\Engineering\Richard Cebour - 07165 & 07166\Drafting\Botts & Thunderbird Road\ASBUILTS\Street & Storm\N1 - 07165.dwg

DATE	P.E. SIGNATURE	DESCRIPTION
06-07-07	R.J.S.	Prepared for Review.
01-25-08	R.J.S.	Revised elevations
06-20-08	R.J.S.	Revised per city comments

**INTERSECTION DETAILS**

**CENTERPOINT-KCS INTERMODAL CENTER**

STATE OF MISSOURI  
 ROBERT J. SUNTA  
 E-25751  
 LICENSED PROFESSIONAL ENGINEER

Reviewed By:	S.E.C.
Designed By:	R.J.S.
Drafted By:	J.W.W.

Lutjen Project No.: 07165

**LUTJEN**

8350 N. Saint Clair Ave.  
 Kansas City, MO 64151  
 816.587.4320  
 816.587.1393 fax  
 www.lutjen.com

surveying  
 planning  
 engineering  
 landscape architecture

Sheet No.:  
**14**