

NOT AS BUILT

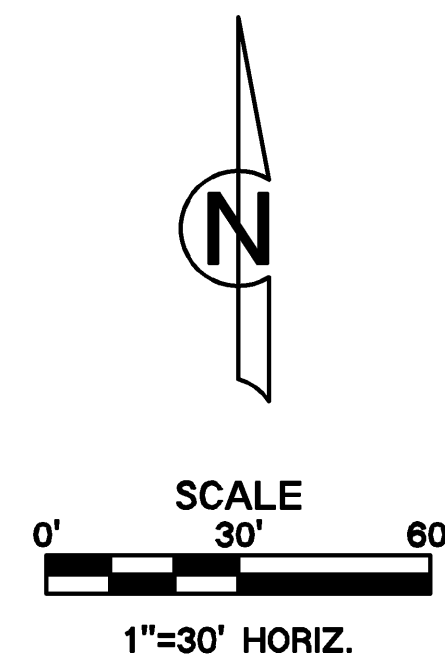

ANDREWS ROAD &  
BOTTTS ROAD

INTERSECTION DETAILS  
CENTERPOINT-KCS  
INTERMODAL CENTER

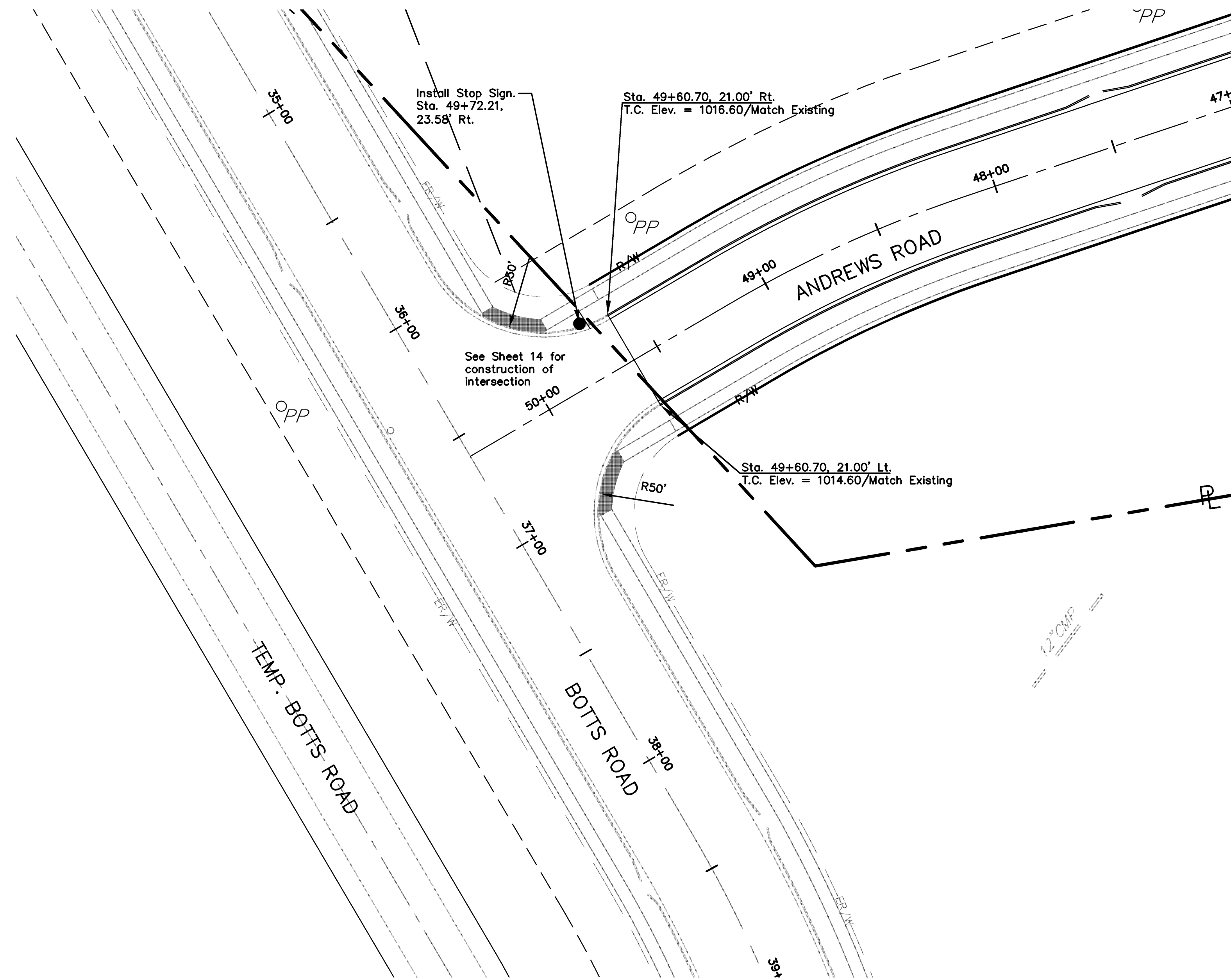
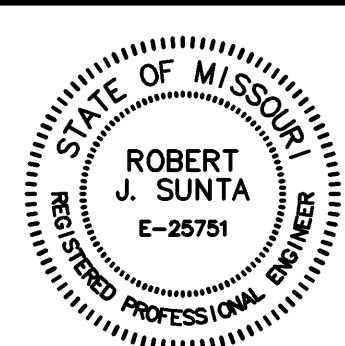

Reviewed By:	S.E.C.
Designed By:	R.J.S.
Drafted By:	J.W.W.

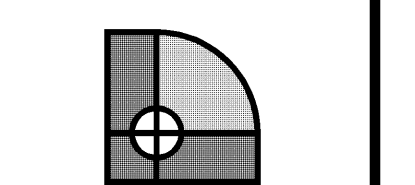

**LUTJEN**

8350 N. Saint Clair Ave.  
Kansas City, MO 64151  
816.587.4320  
816.587.1393 fax  
www.lutjen.com

surveying  
planning  
engineering  
landscape architecture

Sheet No.:  
**33**

DATE	P.E. SIGNATURE	DESCRIPTION
06-07-07	R.J.S.	Prepared for Review.
01-25-08	R.J.S.	Revised Intersection plan
06-20-08	R.J.S.	Revised Intersection plan

Location: N:\Engineering\Richard Gebaur - 07165 & 07166\Drafting\Andrews Road\As built\Street & Storm\INI - 07216.dwg