

CURVE	RADIUS	LENGTH	TANGENT	DELTA	P.I. STA. (BK.)
C	500.00'	103.96'	52.17'	11°54'48"	48+64.18

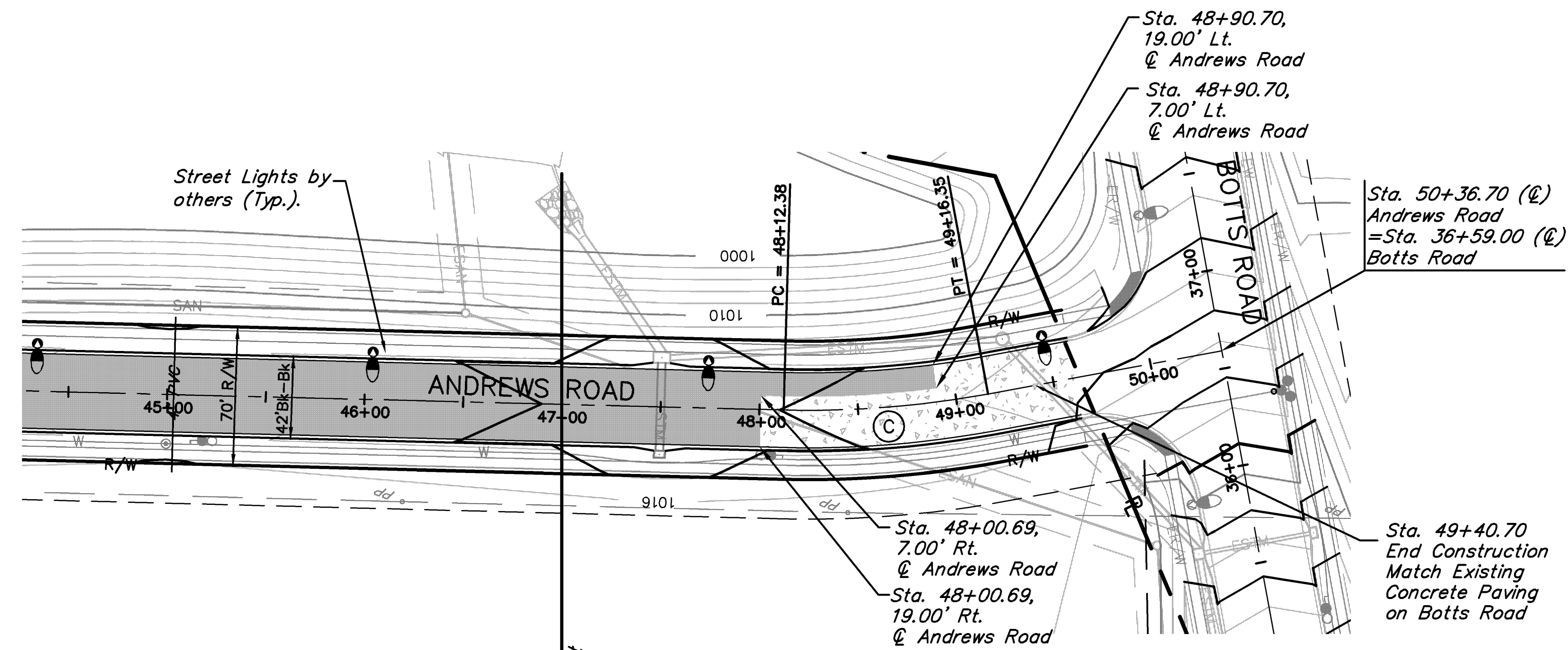

Sta. 47+00.00
=Match Line
See Previous Sheet

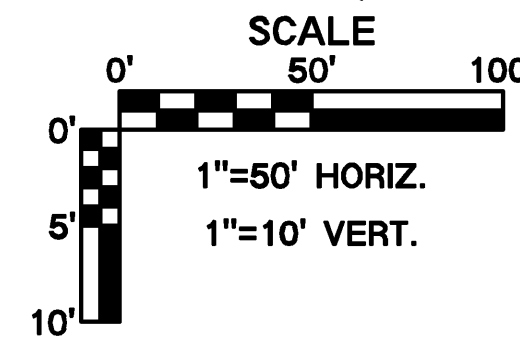
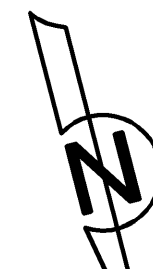

- 11" ASPHALT PAVEMENT
(2" Type 3 asphaltic concrete surface with 9" min. Type 1 asphaltic concrete base course over 6" min. compacted subgrade 95% of standard max. density)
- 8" CONCRETE PAVEMENT
(8" min. portland cement concrete pavement over 6" min. compacted subgrade 95% of standard max. density)

NOT AS BUILT

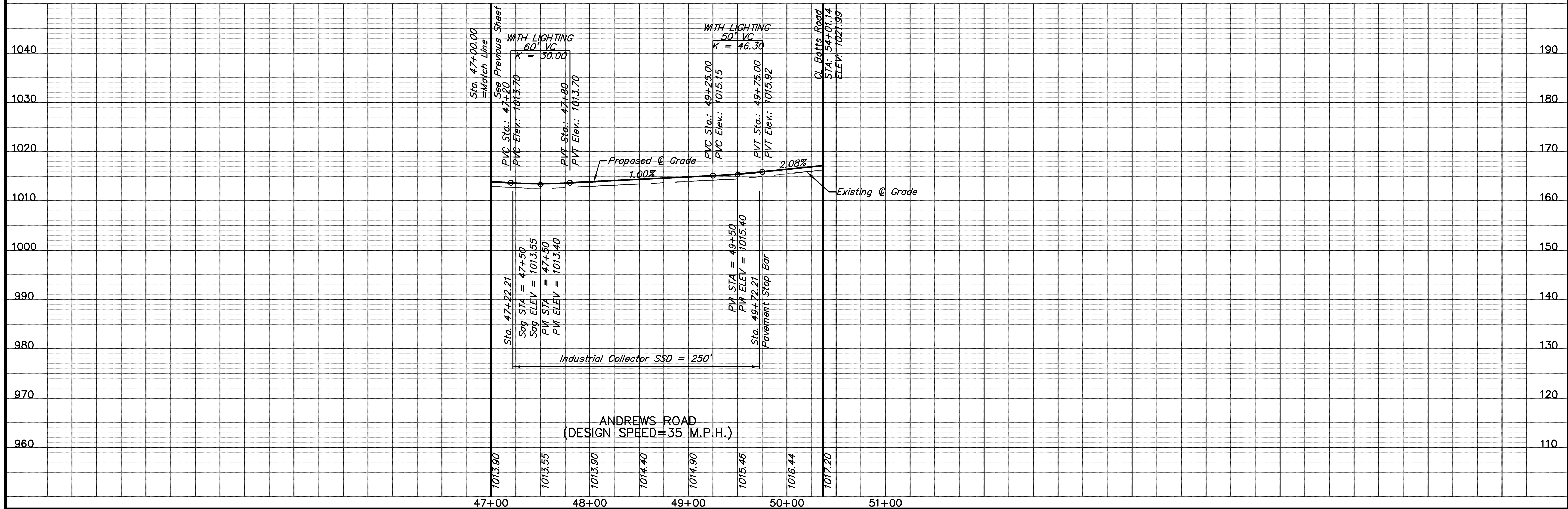

Location: N:\Engineering\Richard Gebaur - 07165 & 07166\Drafting\Andrews Road\As Built\Street & Storm\S14 - 07216.dwg

STREET PLAN & PROFILE

**CENTERPOINT-KCS
INTERMODAL CENTER**

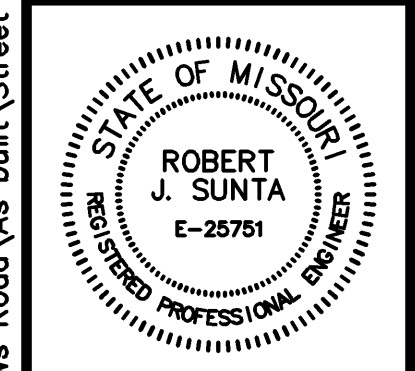

Reviewed By: S.E.C.
Designed By: R.J.S.
Drafted By: J.W.W.
Lutjen Project No.: 07216



Sheet No.:
32

DATE	P.E. SIGNATURE	DESCRIPTION
06-07-07	R.J.S.	Prepared for Review.
01-25-08	R.J.S.	Revised horizontal and vertical alignments
06-20-08	R.J.S.	Revised per city comment