

GENERAL NOTES:

1. THE CONSTRUCTION COVERED BY THESE PLANS SHALL CONFORM TO THE CURRENT STANDARDS AND SPECIFICATIONS OF THE PUBLIC WORKS DEPARTMENT, KANSAS CITY, MISSOURI.
2. ALL MANHOLES, CATCH BASINS, UTILITY VALVES, AND METER PITS TO BE ADJUSTED OR REBUILT TO GRADE AS REQUIRED.
3. THE ASPHALTIC CONCRETE SURFACES ON ALL PERMITTED STREETS SHALL BE VIRGIN MATERIAL.
4. IT SHALL BE THE RESPONSIBILITY OF THE CONTRACTOR TO CONTROL DOWNSTREAM EROSION AND SILTATION DURING ALL PHASES OF CONSTRUCTION.
5. PRIOR TO ORDERING PRECAST STRUCTURES, SHOP DRAWINGS SHALL BE SUBMITTED TO THE DESIGN ENGINEER FOR APPROVAL. UPON APPROVAL, THESE SHALL BE SUBMITTED TO THE CITY PLANNING & DEVELOPMENT - LAND DEVELOPMENT DIVISION FOR REVIEW.
6. THE CONTRACTOR SHALL BE RESPONSIBLE FOR RECORDING ROCK ELEVATIONS AT 25 FOOT (MAXIMUM) INTERVALS WHERE ENCOUNTERED, AND FURNISHING THIS INFORMATION TO THE DESIGN ENGINEER FOR USE ON "AS-BUILT" PLANS.
7. THE UTILITY LOCATIONS SHOWN ON THESE PLANS ARE SHOWN IN AN APPROXIMATE WAY ONLY AND HAVE NOT BEEN INDEPENDENTLY VERIFIED BY THE OWNER OR ITS REPRESENTATIVE. THE UTILITY INFORMATION IS NOT MEANT TO BE ALL INCLUSIVE. THE CONTRACTOR SHALL VERIFY THE LOCATION AND DEPTH OF ALL UTILITIES PRIOR TO CONSTRUCTION. UTILITIES DAMAGED THROUGH THE NEGLIGENCE OF THE CONTRACTOR TO OBTAIN THE LOCATION OF SAME SHALL BE REPAIRED OR REPLACED BY THE CONTRACTOR AT HIS EXPENSE.
8. SEE GEOTECHNICAL REPORT TITLED "REPORT OF SUBSURFACE EXPLORATION AND GEOTECHNICAL EVALUATION" BY TSI ENGINEERING FOR SOIL AND ROCK INFORMATION.
9. EROSION CONTROL PLANS AND PROCEDURES SHALL BE IN PLACE PRIOR TO ANY EXCAVATION.
10. CONTRACTOR SHALL PROVIDE EARTHWORK AND MATERIAL TESTING TO COMPLY WITH THE STANDARD SPECIFICATIONS OF THE CITY PLANNING & DEVELOPMENT - LAND DEVELOPMENT DIVISION OR AS REQUIRED BY THE CITY'S FIELD REPRESENTATIVE.
11. TRENCH BACKFILL FOR STORM SEWERS WITHIN PUBLIC STREET RIGHTS OF WAY SHALL CONFORM TO THE FLOWABLE FILL REQUIREMENTS PER THE REVISED APWA SECTION 2602.3.C, DATED APRIL 2000.
12. FOR CMP PIPE SIZES 48" AND LARGER, DURING PIPE INSTALLATION, INCLUDING PLACEMENT AND CONSOLIDATION OF THE ROCK BEDDING AND BACKFILL TO A POINT 4' ABOVE THE TOP OF THE PIPE, FULL TIME INSPECTION SHALL BE PROVIDED BY A QUALIFIED INSPECTOR WORKING UNDER THE SUPERVISION OF A PROFESSIONAL ENGINEER. AFTER INSTALLATION AND PRIOR TO ACCEPTANCE, CERTIFICATION BY A MISSOURI REGISTERED PROFESSIONAL ENGINEER IS REQUIRED AND SHALL STATE THAT THE INSTALLATION AND BACKFILL CONFORMS TO THE PIPE MANUFACTURERS RECOMMENDATIONS AND THE STANDARD SPECIFICATIONS AND DESIGN CRITERIA OF THE CITY OF KANSAS CITY, MISSOURI.
13. STREET NAME SIGNS ARE TO BE INSTALLED AT ALL INTERSECTIONS IN ACCORDANCE WITH CURRENT STANDARDS AND SPECIFICATIONS OF THE STREET & TRAFFIC DIVISION - PUBLIC WORKS, PRIOR TO FINAL ACCEPTANCE OF THE CONSTRUCTION PERMIT, BY THE STREET PAVING CONTRACTOR.
14. CONTRACTOR IS TO NOTIFY STREETS & TRAFFIC DIVISION - PUBLIC WORKS AT (816) 513-2777 AT LEAST 48 HOURS PRIOR TO PLACEMENT OF PAVEMENT MARKINGS FOR INSPECTION OF STRIPING LAYOUT AND THE DATE OF STOP AND YIELD SIGN INSTALLATION, IF APPLICABLE.
15. STOP SIGN LOCATION AND INSTALLATION SHALL CONFORM TO THE LATEST EDITION MUTCD.
16. CONTRACTOR IS TO NOTIFY KCMO STREET & TRAFFIC DIVISION AT (816) 513-2672 THE DATE OF STOP SIGN INSTALLATION.
17. STREET SIGNS AND POSTS TO BE INSTALLED PER THE CURRENT KCMO APWA GUIDELINES.
18. LINEAR FOOT MEASUREMENTS SHOWN ON THE PLANS ARE HORIZONTAL MEASUREMENTS (NOT SLOPE MEASUREMENTS) FROM CENTER OF STRUCTURE TO CENTER OF STRUCTURE OR END OF END SECTION, UNLESS OTHERWISE NOTED.
19. THE CONTRACTOR SHALL ALSO UTILIZE THE FOLLOWING TOLL FREE PHONE NUMBER PROVIDED BY "MISSOURI ONE CALL SYSTEM, INC." 1-800-DIG-RITE. THIS PHONE NUMBER IS APPLICABLE ANYWHERE WITHIN THE STATE OF MISSOURI.
20. THE CONTRACTOR SHALL PROVIDE AND MAINTAIN ALL TRAFFIC HANDLING MEASURES NECESSARY TO ENSURE THAT THE GENERAL PUBLIC PROTECTED AT ALL TIMES. TRAFFIC CONTROL SHALL CONFORM TO THE MANUAL OF UNIFORM TRAFFIC CONTROL DEVICES (MUTCD - LATEST EDITION).
21. CONTRACTOR IS RESPONSIBLE FOR KEEPING ALL PUBLIC ROADWAYS ADJACENT TO THE CONSTRUCTION SITE FREE OF DIRT AND DEBRIS RESULTING FROM ACTIVITIES RELATED TO THE CONSTRUCTION OF THIS PROJECT. INSPECTIONS AND CLEANUP TO OCCUR ON A DAILY BASIS.
22. CONTRACTOR TO INSTALL ALL SIDEWALK ADA RAMPS PER CURRENT CITY STANDARDS.

NOT AS BUILT

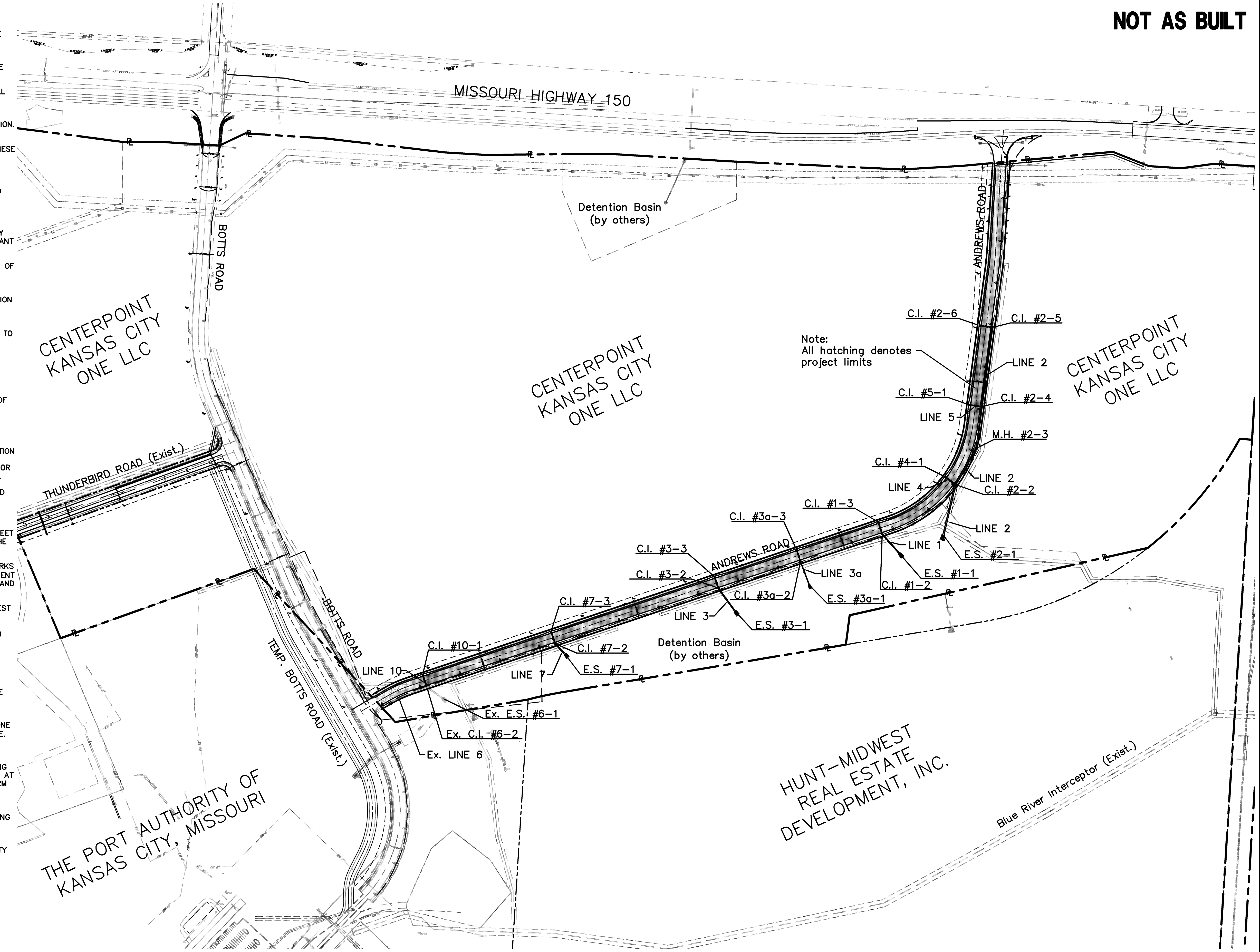

Note:
All hatching denotes project limits

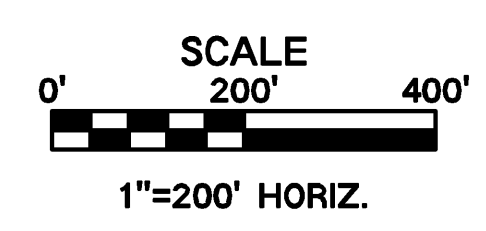

PROPOSED SIGNS	
EXISTING STORM SEWER	
PROPOSED STORM SEWER	
FUTURE STORM SEWER	
EXISTING SANITARY SEWER	
PROPOSED SANITARY SEWER	
FUTURE SANITARY SEWER	
EXISTING WATER MAINS	
PROPOSED WATER MAINS	
FUTURE WATER MAINS	
EXISTING RIGHT-OF-WAY	
PROPOSED RIGHT-OF-WAY	
FUTURE RIGHT-OF-WAY	
PROPERTY LINE	

Location: N:\Engineering\Richard Gebaur - 07165 & 07166\Drafting\Andrews Road\As Built\Street & Storm\SSS - 07216.dwg

Prepared for Review.	R.J.S.	R.J.S.	P.E. SIGNATURE	DESCRIPTION
06-07-07	01-25-08			
STREET & STORM GENERAL LAYOUT				
CENTERPOINT-KCS INTERMODAL CENTER				
Reviewed By:	S.E.C.			
Designed By:	R.J.S.			
Drafted By:	J.W.W.			
Lutjen Project No.: 07216				
8350 N. Saint Clair Ave. Kansas City, MO 64151 816.587.4320 816.587.1393 fax www.lutjen.com surveying planning engineering landscape architecture				
Sheet No.: 26				